



MultiAdjust Advance

A highly adjustable, comfortable and advanced seating solution!

**Assessment &
Prescription Guide**

CareFlex

Features At A Glance

Introducing the NEW MultiAdjust Advance, an enhanced version of our popular MultiAdjust chair designed for individuals with more complex postural care needs such as an increased thoracic kyphosis, kyphoscoliosis, and an altered head position.

The MultiAdjust Advance is a highly adjustable seating system with Tilt-in-Space, Back Angle Recline, and WaterCell Technology that prioritises comfort and functionality. The chair includes an advanced articulating head section with a choice of support as standard to address specific head and spine postural challenges. Removable armrest options also promote independence and safety during transfers. Quick adjustments, available in manual or motorised control options, ensure ease of use without needing tools. Backed by a Lifetime Frame Warranty, the MultiAdjust Advance suits diverse seating needs in health and care environments, maintaining CareFlex's renowned quality and reliability.

CLIENT GROUPS

- Semi-ambulant and non ambulant
- Frail and elderly
- Neurological conditions (e.g. multiple sclerosis, muscular dystrophy, motor neurone disease)
- Cardiovascular conditions
- Orthopaedic conditions
- Increased thoracic kyphosis and other postural challenges of the head and spine

ENVIRONMENTS

- Nursing and residential homes
- Hospital wards
- Hospices and respite care
- Domestic and home care

OPTIONAL EXTRAS

- Tilt-in-Space Inclinator
- Lateral Supports (Standard, Curved or Kidney)
- Choice of Positioning Aids
- Soft Headrest (Shallow, Deep or Profiled)
- Pommel
- Tray
- Dynamic Air Seat Cushion (for high pressure care needs)

STANDARD FEATURES (Included in the Price)

- Tilt-in-Space
- Back Angle Recline
- Articulating Head Section
- Head Section Support*
- Back Support*
- Elevating & Negative Angle Leg Rest
- Flip Up & Angle Adjustable Footplate
- Integral Seat Depth Adjustment
- Integral Seat Width Adjustment
- Integral Arm Height Adjustment
- Removable Armrests*
- WaterCell Technology Seat Cushion
- Four Braked Castors
- Fabric Colour Choice*

ADJUSTMENT CONTROL OPTIONS

- Manual
- Pro-Control (Leg Rest and Tilt-in-Space functions only)
- Fully Motorised

*Choose From:

- Flat or Waterfall Head Section Support
- Reflexion Foam Flat Back, Waterfall, or Contoured Back Support
- Standard or Transfer-Assist Removable Armrests
- Fabric Colour Choice from our Simply Colours Range

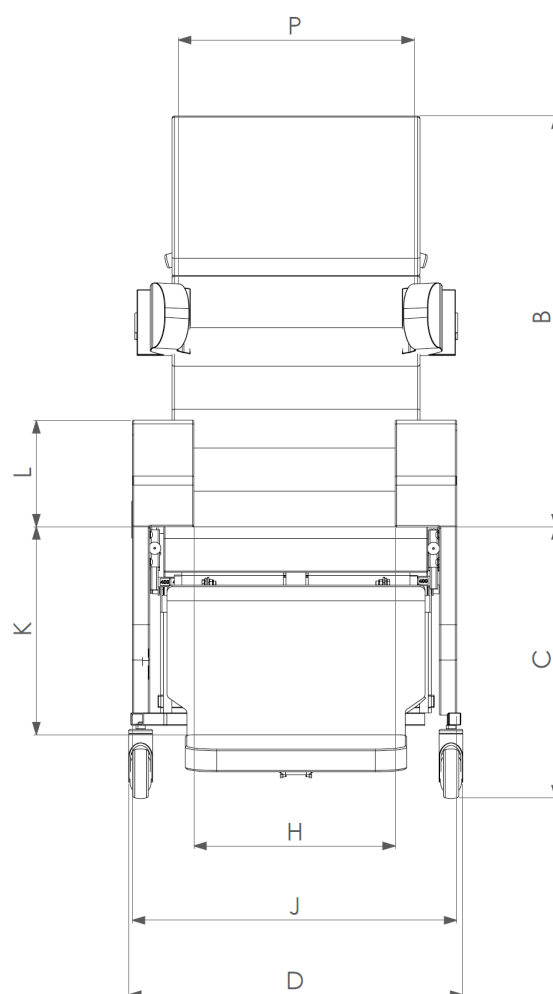
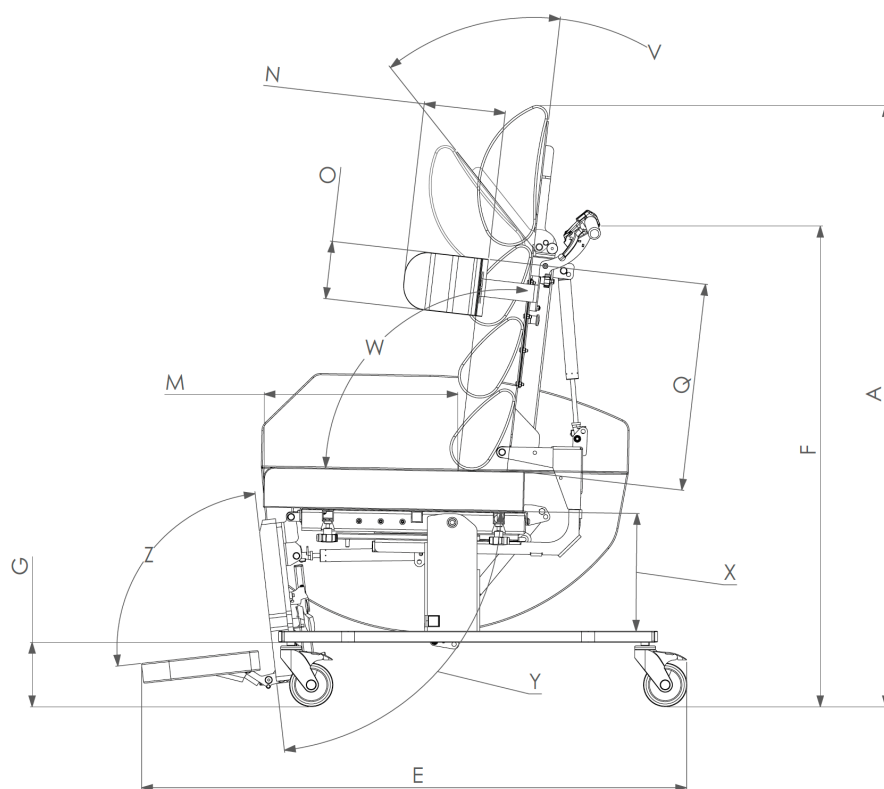

Technical Data

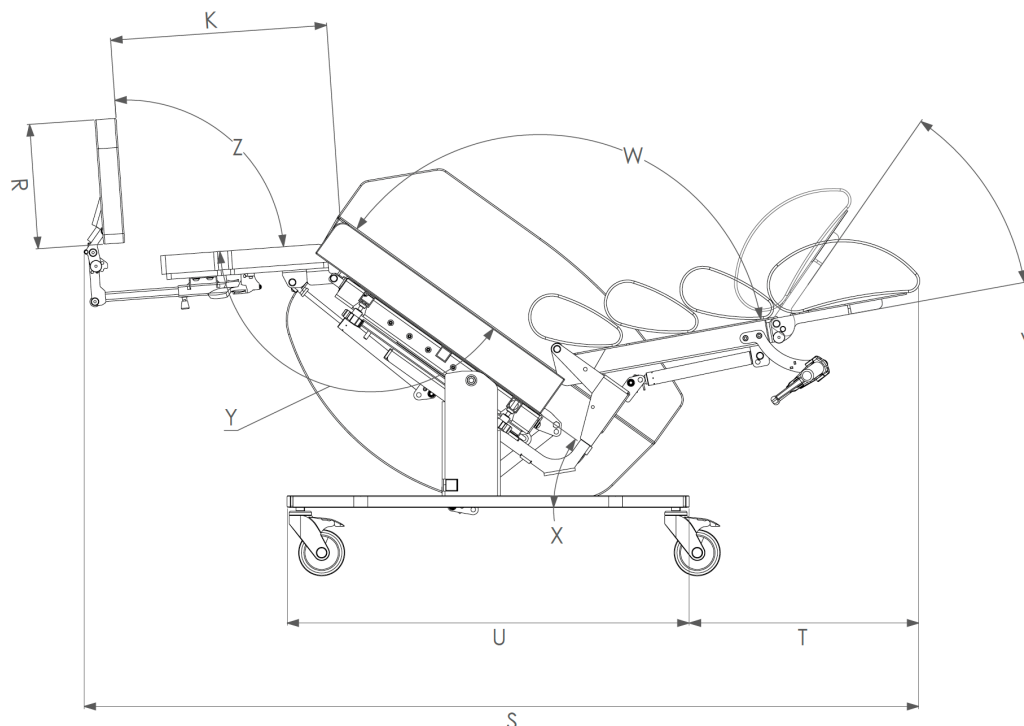

Adjustments	
H: Seat Width (inner)	400 mm (16") to 550 mm (21") (150 mm range – 2 cushion sizes)
J: Max Width (outer)	790 mm (31")
K: Seat to Footplate Height	350 mm (14") to 500 mm (20") (150 mm range)
L: Armrest Height	200 mm (8") to 250 mm (10") (50 mm range)
M: Seat Depth	380 mm (15") to 550 mm (21") (170 mm range)
N: Lateral Pad Depth	Small: 160mm (4.5") Medium: 190mm (7.5")
O: Lateral Pad Height	130mm (5")
P: Narrow Lateral Width	230 mm (9") to 370 mm (15") (140 mm range)
P: Regular Lateral Width	335 mm (13") to 475 mm (19") (140 mm range)
P: Wide Lateral Width	440 mm (17") to 580 mm (23") (140 mm range)
Q: Lateral Height	320 mm (12") to 520 mm (20") (200 mm range)
R: Footplate Depth	270mm (10.5")
S: Maximum Extended Chair Length	1660mm (65")
T: Tilt-in-Space (TiS) Clearance	500mm (20")
U: Base Frame Length	870mm (34")
V: Head Section Articulation	4 Positions 90° 75° 60° 45°
W: Back Angle Recline (BAR)	95° to 135° (40° range) (Manual & Motorised)

Adjustments	
X: Tilt-in-Space (TiS)	Factory Setting: 0° to 35° (35° range) (Manual & Motorised)
	Optional Setting: -5° to 30° (35° range) (Manual & Motorised)
Y: Leg Rest Angle	Factory Setting: 65° to 135° (70° range) (Manual & Motorised)
	Optional Setting: 80° to 150° (70° range - Manual)
	Optional Setting: 80° to 157° (77° range - Motorised)
Z: Ankle Angle	Four Positions – 75° / 90° / 105° / 120°

Basic Dimensions	
A: Overall Height	1350 mm (53")
B: Back Height	830 mm (32")
C: Seat Height	540 mm (21")
D: Castor Frame Width	675 mm (26")
E: Overall Length (inc Footplate)	1285 mm (50")
F: Push Bar Height	1125 mm (44")
G: Clearance Height	145 mm (6")
Maximum User Weight	160kg
Chair Weight	70kg (Manual) 73kg (Motorised)

(All measurements ±10mm / 5°)

Taking Measurements

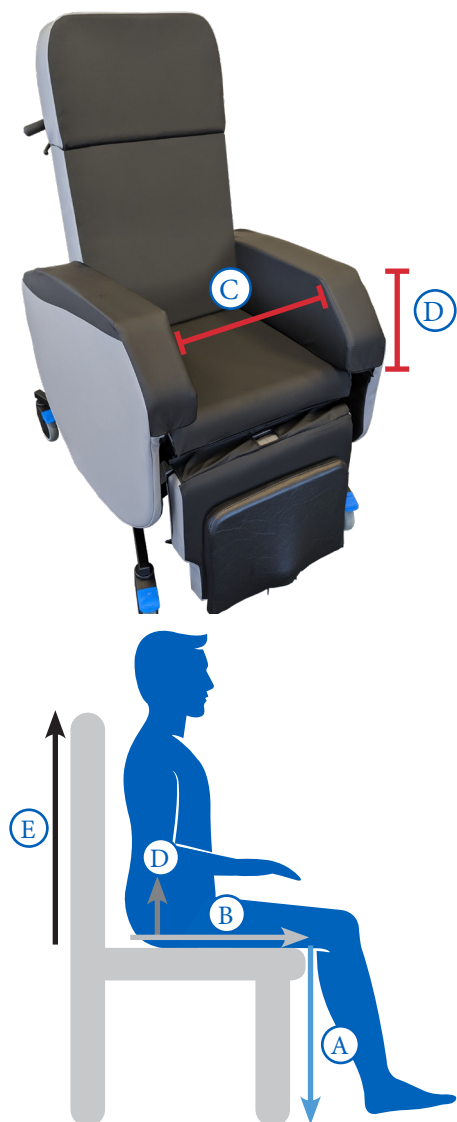

Every chair must be set-up to fit its user, ensuring maximum contact with the chair, distributing their weight evenly, and supporting them sufficiently.

This not only promotes comfort and functionality, but also reduces the risk of postural deterioration and pressure injury. The correct chair dimensions and correct angle selection protects the body structure, encourages optimum physiological function, and enables safe use of the chair.

Ensure optimum sitting position before measuring.

A) Seat height - back of knee to footplate/floor

B) Seat depth - back of the pelvis to the back of the knee minus approx. one inch (both left and right measured)

C) Seat width - hip width/two widest points plus up to 0.5 inch each side

D) Armrest height - seat base to elbow (both left and right measured)

E) Back height - seat base to back of head

Back angle - dependent on hip range of movement

Leg rest angle - dependent on knee range of movement

These are guidelines only as will be affected by the individual's size and shape, and the functions and accessories indicated.

	ADJUSTMENT RANGE / OPTIONS	MEASUREMENT TAKEN
Seat Depth	380 mm - 550 mm	
Seat Width ¹	400 mm - 550 mm	
Seat to Footplate Height	350 mm - 500 mm	
Armrest Height ²	200 mm - 250 mm	

¹Armrests can be set at different seat widths from front to back and left to right, which may be indicated for users with fixed lower limb postures such as windsweeping, or those with increased body mass in the gluteal and hip areas.

²Armrest height can be set differently from front to back resulting in angled armrests, which may be indicated for users with specific upper limb positioning requirements.

Pressure Care

Posture and pressure are inextricably linked; body posture and positioning have a direct influence on the pressure going through specific body sites¹. When an individual is sitting, pressure is exerted through their skin onto the soft tissues. If they are not appropriately supported, in an upright stable position, or if they cannot reposition themselves, this pressure can result in poor blood flow causing direct damage to cells. The body can only withstand high interface pressures for a very short period, and when the pressure is not regularly relieved pressure ulcers can develop². Damage to tissues can also result from friction and/or shear forces when a person slumps in a chair, as observed in those with reduced postural control, pelvic instability, or generalised weakness.

Prevention of pressure ulcers can not only improve an individual's outcomes and quality of life, but it can also reduce the costs to health and social care services benefitting the wider community. Specialist seating systems aim to reduce the risk of pressure injuries by distributing the user's body weight evenly throughout the chair over the maximum surface area with posture supported as aligned and symmetrical as possible.

A key intervention for prevention is pressure redistribution³, and repositioning is believed to be one of the most effective methods for preventing skin damage. Tilt-in-Space can be utilised to redistribute pressure by changing the tilt angle of the chair on a regular basis, and can also be used in combination with Back Angle Recline.

Tilt-in-Space and Back Angle Recline should always be prescribed responsibly, ensuring that they are safe and appropriate for the user following a comprehensive assessment of posture and risk, with advice sought from the multi-disciplinary team where indicated. In some cases, these functions will be contraindicated, and they could also increase shear and friction forces.

Professional guidance from a Tissue Viability Nurse or District Nurse may be indicated.

1. Sprigle S, Sonenblum S (2011) Assessing evidence supporting redistribution of pressure for pressure ulcer prevention: *A review Journal of Rehabilitation Research and Development* **48**(3):203-214

2. Waterlow (2007) *Pressure Ulcers* Available from: <http://www.judy-waterlow.co.uk>

3. NHS (2017) *Pressure ulcers (pressure sores)* Available from: <https://www.nhs.uk/conditions/pressure-sores/treatment/>

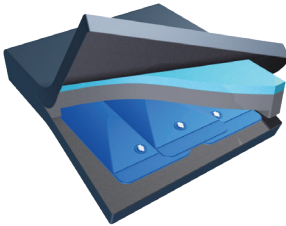
CUSHION TYPE	DESCRIPTION	SELECTION
<p>CareFlex Watercell Technology</p> 	<p>Our WaterCell Technology provides a reliable and dynamic pressure care solution for people at medium to high risk of pressure injury. The water cells work by allowing the seat cushion to contour naturally and effectively around the user's body. The layer of Visco-Elastic Memory Foam moulds to the shape of the buttocks and thighs, distributing weight over a larger surface area and minimising pressure build-up under bony areas. It enables the individual to achieve a stable and functional posture without compromising on pressure care and comfort.</p>	<p><input type="checkbox"/> Standard Size</p> <p><input type="checkbox"/> Large (indicated if chair to be used at maximum seat width) Optional Extra</p>

Postural Support

When an individual's ability to achieve good posture is affected, either through age, illness, injury or disability, it can have a significant impact on their health and wellbeing. Specialist seating aims to allow individuals, who might otherwise have difficulty, to achieve their optimum sitting posture to sit out comfortably, interact with their environment, participate in activities of daily living and enhance physiological function.

The MultiAdjust Advance offers a range of functions and accessories to promote good postural support at all body segments, especially pelvic stability, trunk and head alignment, and foot support.

Articulating Head Section

- The MultiAdjust Advance includes an articulating head section with a choice of support as standard.
- Indicated for specific head and spine postural challenges, such as an increased thoracic kyphosis.
- Full support is achieved either through correcting, where appropriate, or accommodating to the shape of the user.

Back Angle Recline (BAR)

- Seat to back angle adjusts to open up the hip angle.
- Assists with comfort.
- Accommodates reduced hip flexion range of movement.
- Helps alleviate pain associated with hip joint problems.
- Reduces abdominal pressure.
- Can relieve hamstring muscles tension if the leg rest is elevated.

Tilt-in-Space (TiS)

- Seat to back angle remains the same - whole system tilts posteriorly.
- Promotes pelvic stability.
- Encourages pressure redistribution.
- Manages energy levels.
- Assists with hoisting and positioning.

BAR and TiS should be prescribed responsibly, ensuring they are safe and appropriate for the user following a comprehensive assessment of posture and risk.

Removable Armrests

- Fully removable armrests will facilitate lateral transfers from both sides to promote independence and encourage activity.
- It can also assist with sling application and removal for improved positioning.
- Transfer-Assist armrests specifically support transfers that use active standing hoists and encourage optimum pelvic positioning in the chair.

Adjustable Lateral Support

- External and removable trunk control with independent height and width adjustment.
- May be indicated for individuals who require firmer postural support to achieve an optimum midline position.

Negative Angle Leg Rest

- Accommodates limited knee range of movement allowing a more comfortable seating position.
- The angle required should be determined during the assessment and reflected in the care plan; the elevating function may be contraindicated.

Angle Adjustable Footplate



- On average, 19% of an individual's body weight is distributed through their feet when seated.¹
- Foot support at the correct angle is essential to reduce the risk of pressure injury.
- Also encourages postural stability, allowing freedom of movement in the upper limbs from the load bearing role.

1. Collins F (2001) An adequate service? Specialist seating provision in the *UK Journal of Wound Care* **10**(8):333–337











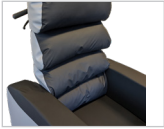

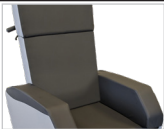
Postural Support

TYPE	MEDIUM MULTIADJUST ADJUSTMENT RANGE	MEASUREMENT / SELECTION
Lateral Support Width (If Applicable)	Narrow: 230 mm to 370 mm (140 mm range) Regular: 335 mm to 475 mm (140 mm range) Wide: 440 mm to 580 mm (140 mm range)	
Lateral Support Height (If Applicable)	320 mm to 520 mm (200 mm range)	
Back Angle Recline (BAR)	95° to 135° (40° range) (Manual & Motorised)	
X: Tilt-in-Space (TiS)	Factory Setting: 0° to 35° (35° range) (Manual & Motorised)	<input type="checkbox"/>
	Optional Setting: -5° to 30° (35° range) (Manual & Motorised)	<input type="checkbox"/>
Y: Leg Rest Angle	Factory Setting - 65° to 135° (70° range) (Manual & Motorised)	<input type="checkbox"/>
	Optional Setting: 80° to 150° (70° range - Manual)	<input type="checkbox"/>
	Optional Setting: 80° to 157° (77° range - Motorised)	<input type="checkbox"/>
Z: Footplate Angle	4 Positions - 75° / 90° / 105° / 120°	
Adjustment Control Option	Manual / Pro-Control (Leg Rest & TiS Only) / Fully Motorised	
Head Section Articulation	4 Positions - 90° / 75° / 60° / 45°	

Optional Extras

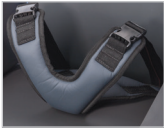
TYPE	DESCRIPTION	IMAGE	SELECT
Head Section Support - Waterfall	<ul style="list-style-type: none"> Support for the head with a focus on comfort and pressure care. 		<input type="checkbox"/>
Head Section Support - Flat	<ul style="list-style-type: none"> Balances support with pressure care without affecting peripheral vision. 		<input type="checkbox"/>
Removable Armrests	<ul style="list-style-type: none"> Facilitates lateral transfers from both sides to promote independence and encourage activity. Can also assist with sling application and removal for improved positioning. Available in Standard or Transfer-Assist Transfer-Assist armrests specifically support active standing hoist transfers and encourage optimum pelvic positioning. 		<input type="checkbox"/>

Optional Extras Continued

TYPE	DESCRIPTION	IMAGE	SELECT
Waterfall Back	<ul style="list-style-type: none"> Promotes effective posture management and pressure care whilst enabling user comfort. The internal soft filling in the pillows can be configured to accommodate kyphotic or lordotic postures to reduce the pressure at the curves' apex and fully support the spine. 		<input type="checkbox"/>
Contoured Back	<ul style="list-style-type: none"> Provides gentle lateral feedback and support for the trunk. Centralises the posture with contoured pads. Available in two widths (450mm/500mm) and provides two different lateral support height options. 		<input type="checkbox"/> _____
Flat Back	<ul style="list-style-type: none"> Balances comfort and pressure care with the promotion of active engagement in sitting. It can also be used with external laterals where greater trunk support is indicated. 		<input type="checkbox"/>
Pommel	<ul style="list-style-type: none"> Encourages thigh alignment. Assists with maintaining pelvic stability. 		<input type="checkbox"/>
Lateral Supports (Curved, Flat or Kidney Shaped Pads)	<ul style="list-style-type: none"> External and removable trunk control with independent height and width adjustment. May be indicated for individuals who require firmer postural support to achieve an optimum midline position. Available in Narrow/Regular/Wide with Curved, Flat or Kidney shaped pads. 		<input type="checkbox"/> _____
Soft Headrest	<ul style="list-style-type: none"> A comfortable rectangular pillow to support the head. Available in shallow and deep. 		<input type="checkbox"/> _____
Soft Profiled Headrest	<ul style="list-style-type: none"> A contoured pillow to support shoulders, neck and head. Encourages head alignment for interaction and optimum physiological function. 		<input type="checkbox"/>
Padded Pelvic Belt*	<ul style="list-style-type: none"> Intervention for anterior pelvic stabilisation. Additionally, can be utilised as a safety belt when portering. 		<input type="checkbox"/>
4-Point Padded Pelvic Belt*	<ul style="list-style-type: none"> Includes secondary straps that pull down over the thighs at right angles to the seat base to maximise pelvic stability. Centre pull adjustment and comfort pads to reduce pressure on the front of the pelvis. 		<input type="checkbox"/>
Groin Harness*	<ul style="list-style-type: none"> Positioning aid that provides maximum pelvic control. Prevents the user from sliding forward in the seat and helps stabilise the position of the pelvis. 		<input type="checkbox"/>
Dynamic Chest Harness*	<ul style="list-style-type: none"> Provides anterior support and comfort whilst not restricting active positioning and function. Lower straps have multi-direction buckles that swivel to avoid twisting and provide comfort. 		<input type="checkbox"/>
Tray	<ul style="list-style-type: none"> Additional upper limb support, where indicated. Offers a platform for activities and communication aids. 		<input type="checkbox"/>
Detachable Footplate Pad	<ul style="list-style-type: none"> To provide greater comfort; attaches to the footplate. Available in 25mm, 50mm, 75mm and 100mm. 		<input type="checkbox"/> _____

All belts and harnesses (positioning aids) must be prescribed, implemented, and monitored responsibly following a comprehensive risk assessment. Please see the following for further information:

- Medicines and Healthcare Regulatory Agency (MHRA) (2015) *MDA/2015/018 All posture or safety belts fitted to supportive seating, wheelchairs, hoists and bathroom equipment* London: MHRA
- British Standard (BS) (2019) *8625:2019 Selection, placement and fixation of flexible postural support devices in seating* London: BSI

Assessment Notes:

[illegible]

[illegible]

CareFlex Ltd
Templer House
King Charles Business Park
Old Newton Road
Heathfield
Newton Abbot
TQ12 6UT

0800 018 6440
info@careflex.co.uk
www.careflex.co.uk

